

# BRAINTREE DISTRICT LOCAL HIGHWAYS PANEL



THIS MEETING IS OPEN TO THE PUBLIC

<http://www.braintree.gov.uk/meetings>

## AGENDA

**Date:** Monday 18<sup>th</sup> January 2016

**Time:** 6.00pm

**Venue:** Committee Room 1, Causeway House, Braintree, CM7 9HB

**Membership:-**

Essex County Council	Braintree District Council	Braintree Assoc of Local Councils
Councillor D Louis	Councillor J Abbott	Councillor J Bendall
Councillor Lady Newton	Councillor M Banthorpe	Councillor S Wilson
Councillor J Pike	Councillor R Mitchell	Councillor D Gronland
Councillor R Walters	Councillor B Rose	Councillor D Smith

1. **Apologies for Absence**
2. **Declarations of Interests.** To declare the existence of any interests relating to items on the Agenda having regard to the Code of Conduct for Members and having taken appropriate advice (where necessary) before the meeting.
3. **Minutes.** To approve as a correct record the Minutes of the meeting of the Braintree District Local Highways Panel held on 24<sup>th</sup> September 2015 (copy previously circulated).
4. **Matters Arising.** To consider matters arising from the Minutes which are not covered on the Agenda.
5. **Question Time.** (See paragraph on Page (ii) of the Agenda)
6. **Scheme Update.**  
  
Valentine Way, Silver End LBRA152061 – (Report attached)  
  
Church Road, Hatfield Peverel LBRA153001 - (Report attached)
7. **Schemes for Consideration by the Panel.** To consider and determine those schemes which should remain or be removed from the potentials scheme list for consideration within the 2016/17 financial budget. (Report attached)
8. **Schemes Already Recommended for Approval and Programmed for Delivery.** Schemes recommended for approval which have been programmed for delivery, or delivered. (Report attached)

Cont'd

9. To consider any other items which the Chairman has decided are urgent.
10. **Dates for Meetings of the Panel.** To note the following date of forthcoming meetings of Braintree District Local Highways Panel:-

24<sup>th</sup> March 2016

### **QUESTION TIME**

Immediately after the Minutes of the previous meeting have been approved there will be a period of up to 30 minutes when members of the public can speak for up to three minutes each on items on the Agenda. Members of the public wishing to speak should contact both [matthew.valentine@essexhighways.org](mailto:matthew.valentine@essexhighways.org) and [alison.webb@braintree.gov.uk](mailto:alison.webb@braintree.gov.uk) at least two working days prior to the meeting. Members of the public can remain to observe the whole of the public part of the meeting.

Councillors who are not Members of the Panel are reminded that if they wish to speak at the meeting they should contact Matt Valentine and Alison Webb as indicated above and below.

### **Health and Safety**

Any persons attending meetings at Causeway House are requested to take a few moments to familiarise themselves with the nearest available fire exit, indicated by the fire evacuation signs. In the event of a continuous alarm sounding during the meeting, you must evacuate the building immediately and follow all instructions provided by a Council officer who will identify him/herself should the alarm sound. You will be assisted to the nearest designated assembly point until it is safe to return to the building.

If you require any further information relating to this Agenda, or wish to forward your apologies for absence, please contact either Matt Valentine on 01245 435335 email [matthew.valentine@essexhighways.org](mailto:matthew.valentine@essexhighways.org) or Alison Webb on 01376 552525 email [alison.webb@braintree.gov.uk](mailto:alison.webb@braintree.gov.uk)

E WISBEY  
Governance and Member Manager

## **Valentine Way, Rivenhall LBRA152061 – Grasscrete improvements**

Please find a copy of the proposed work at the above location.

The target cost for the work is £120,000. However, the cost of the works has increased from the original budget estimate of £70,000, due to the restricted working hours (required by the close proximity of Silver end Primary School) kerb improvements and proposed footway crossover.

With the agreement from the Braintree LHP Members, we can be in a position to increase the original budget by £50,000 to meet the delivery cost through the Cabinet Member Action process from the 2016/17 financial year's budget and not delay the start of work this financial year.

The reason as to why we cannot delay the start is due to the £10,000 a piece contribution from both Greenfields Community and Silver End Primary School.

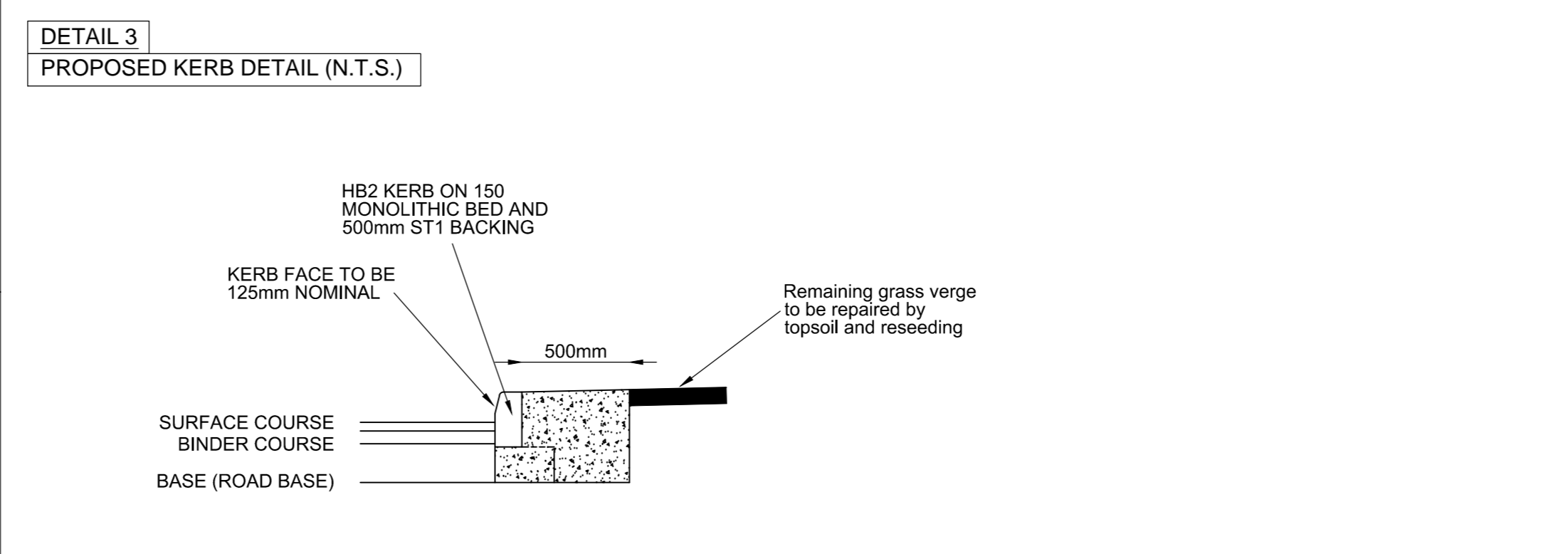
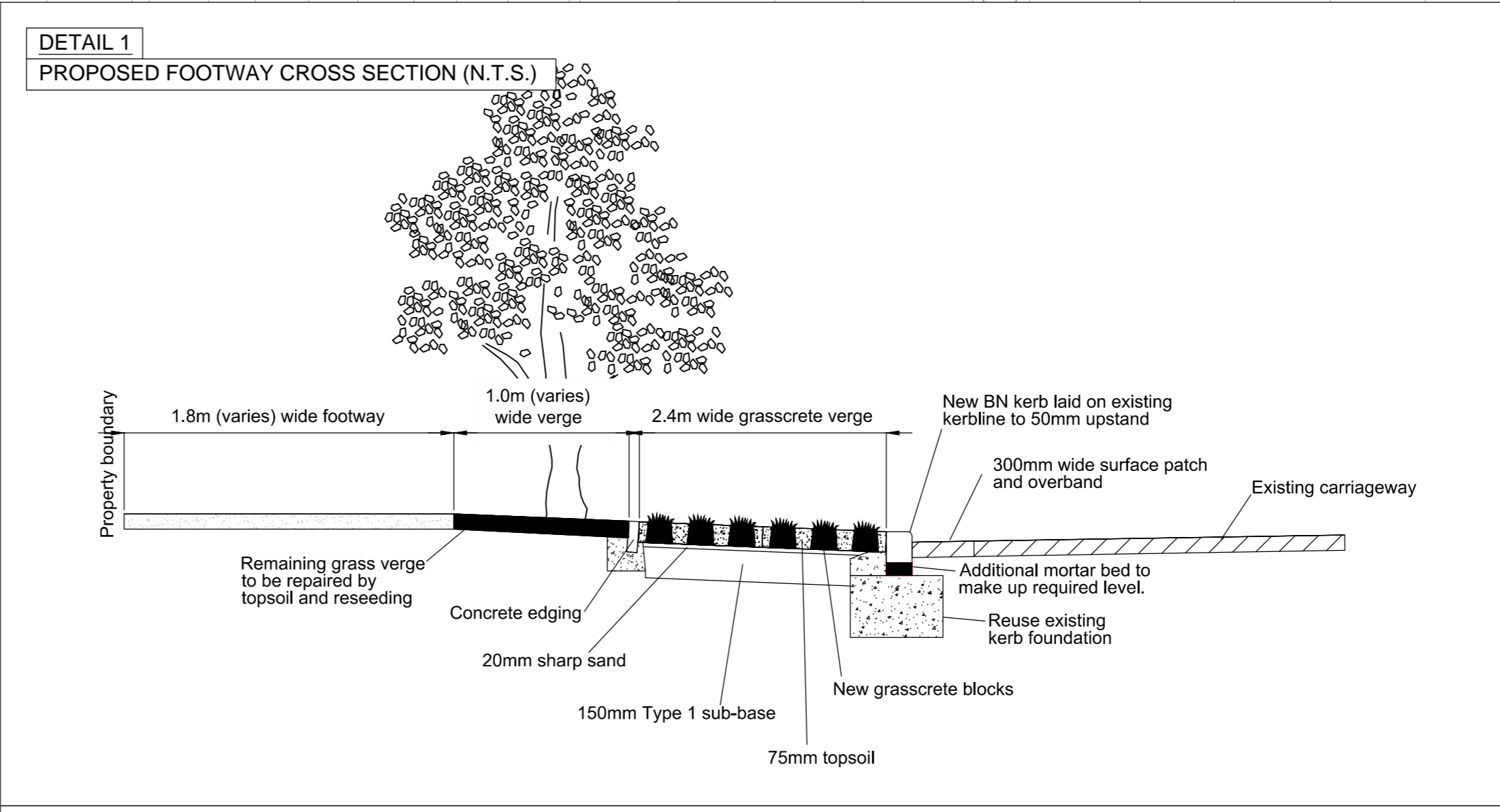
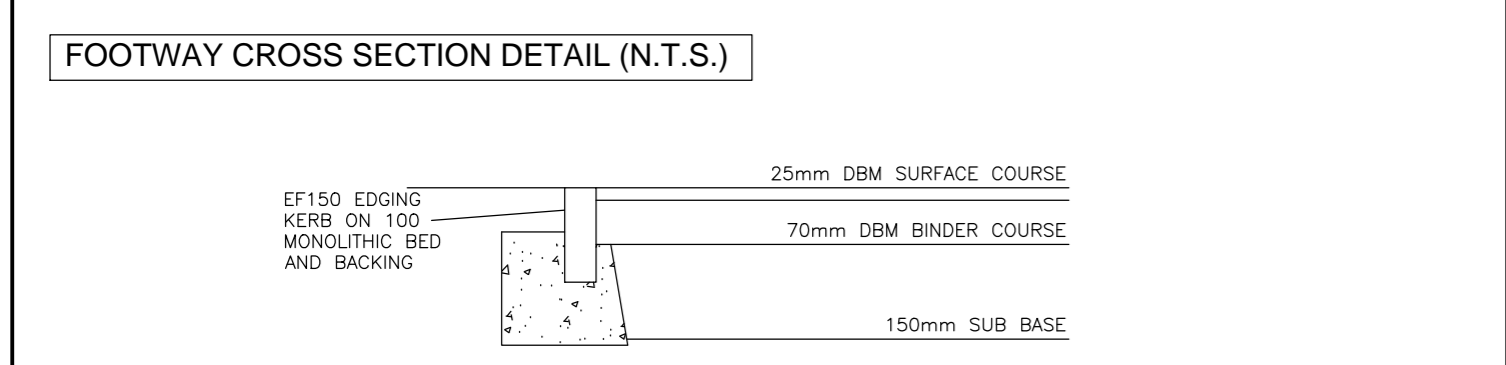
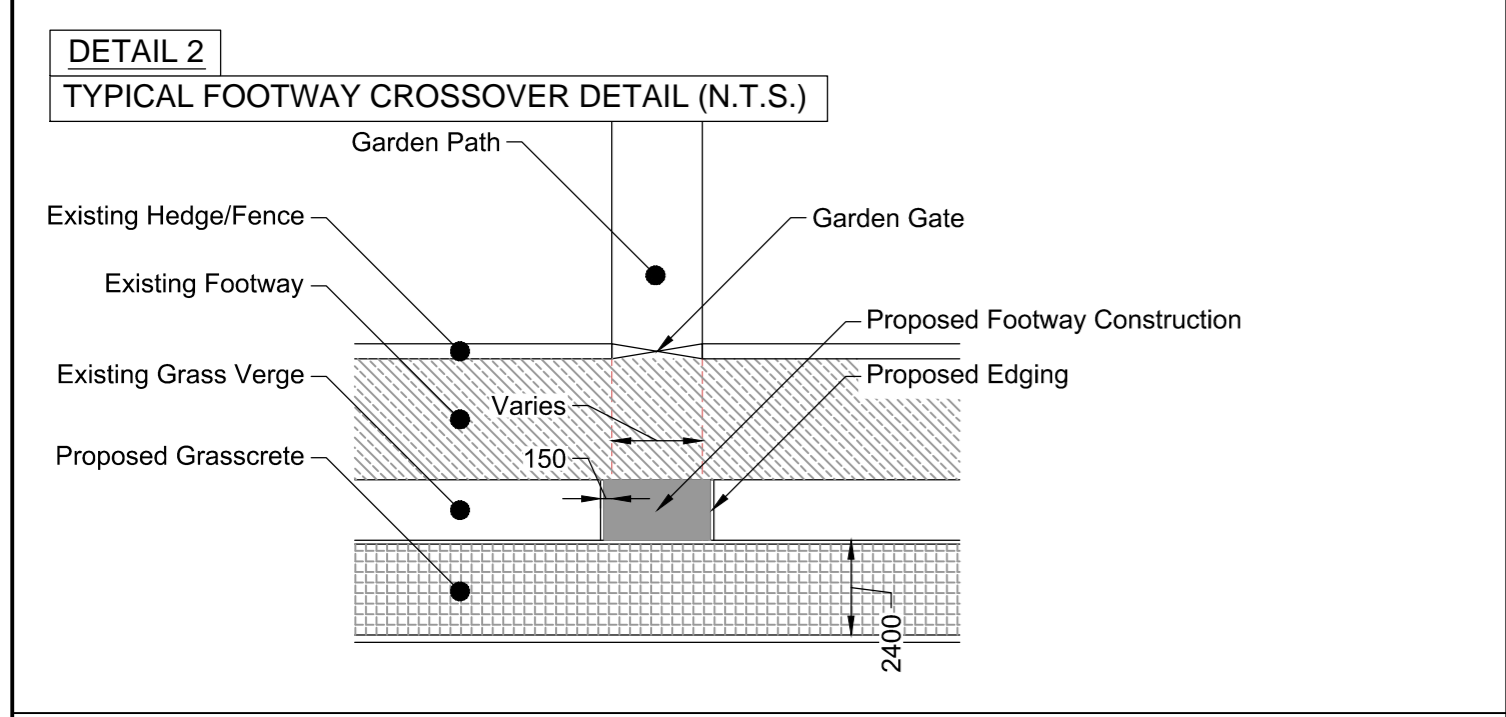
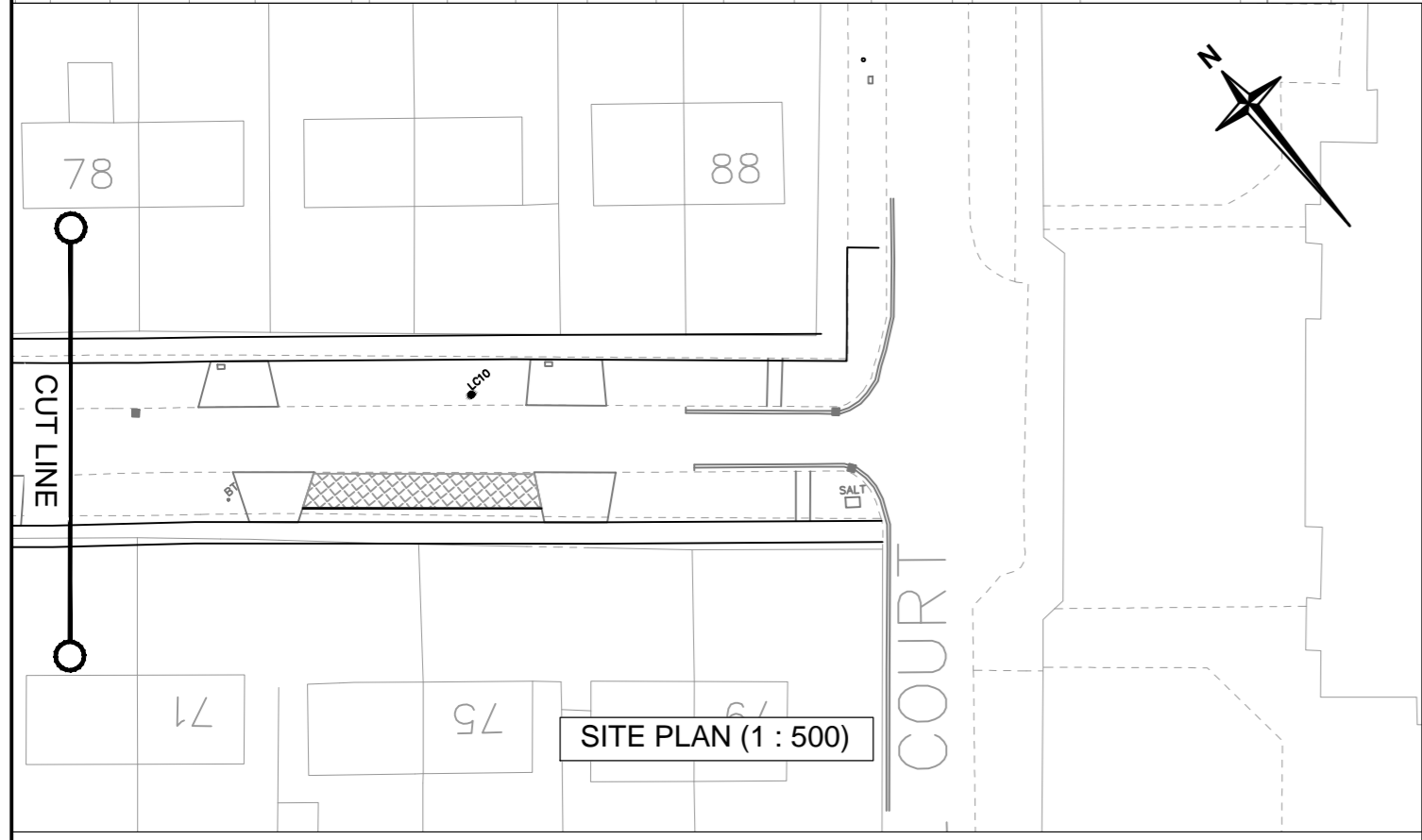
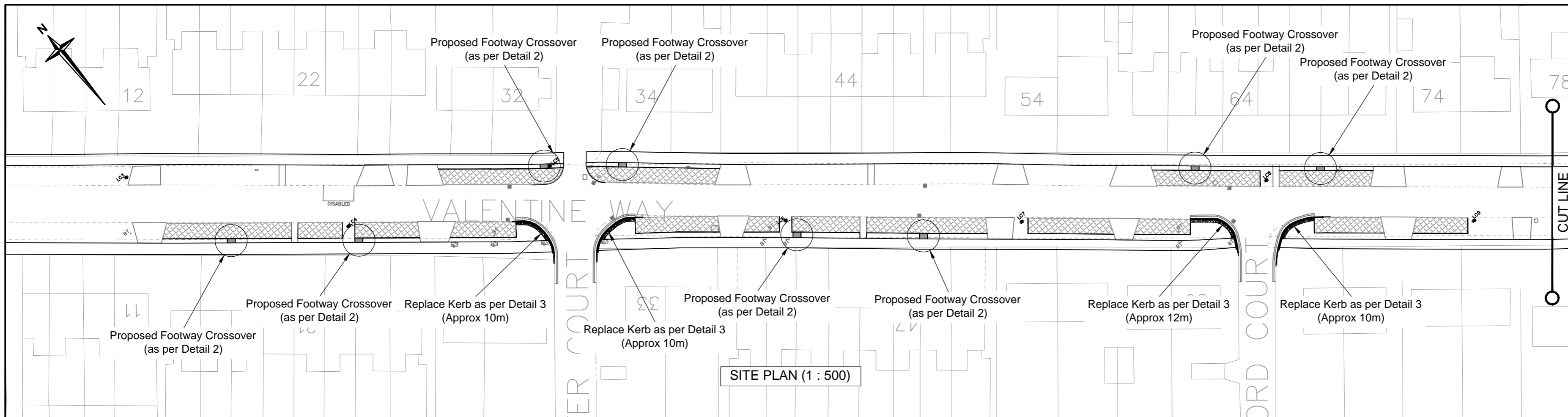

- Notes**
- Do not scale.
  - This drawing is to be read in conjunction with all other contract drawings and documents
  - Engineer to agree location on site.
  - All works to be in accordance with the Department for Transport's Specification for Highway Works and Essex County Council Specifications and Standard Construction Drawings.
  - Drawings of existing Statutory Undertakers' plant have been obtained and are included in the drawings provided to The Contractor. The Contractor shall be responsible for ensuring that all Statutory Undertakers' plant is located prior to commencing works and the protection of such plant is required.
  - Any disturbance to existing grassed areas is to be made good with topsoil and grass seed.
  - Grass verge reinforcement to be carried as per the manufacturers instructions.

Grasscrete installation as per Detail 1

Footway construction as per Detail 2

Kerb replacement as per Detail 3

Rev.	Date	Description of revision	Drawn	Checked	Reviewed	Approved

DRAWING STATUS  
**FOR CONSTRUCTION**



Mark Rowe, Service Director, Highways  
Seax House, Victoria Road South, Chelmsford, CM1 1QH.  
Tel: 0845 6037631 © Essex County Council

SCHEME TITLE  
**VALENTINE WAY  
SILVER END  
LBRA152061**

DRAWING TITLE  
**PROPOSED  
VERGE WORKS**

DESIGNED	DRAWN	CHECKED	REVIEWED	APPROVED
RDA	RDA	IHJ	RDA	NF
DATE	DATE	DATE	DATE	DATE
3/11/15	3/11/15	3/11/15	12/11/15	12/11/15

DRAWING UNITS U.N.O. DIMENSIONS IN MILLIMETRES LEVELS IN METRES  
SCALE AT A2 (594x420mm)  
As Shown

DRAWING No. **HI4272-11-001** REV. -

## Church Road, Hatfield Peverel LBRA153001 - Proposed Footway

Following discussions with the Arboricultural Consultant the trees at this location are on private land and protected by a Tree Preservation Order (TPO). Therefore, we are **not** to excavate in the protected zones around the trees.

It would mean we cannot install concrete kerbs nor construct a footway as first planned. The only way we can see to construct anything in this area is to use a Cellular Confinement system which would mean using bolt-down plastic kerbs on the edge of the existing carriageway, pegged in wooden edgings at the rear of the footway and apply loose road planning on the footway.

The Cellular Confinement system will ensure the roots beneath are protected from heavy loads by confining the sub-base and stabilising the ground. The cellular system would be filled with an absorbent, free-flowing aggregate to ensure passage of air and water providing essential nutrients to the roots. (See diagram below)



Location in question.

The cellular system would be cheaper but unlikely to provide the value for money.

Things to consider:

- This footway will have a loose surface allowing rainwater to drain through to the tree roots.
- The loose surface will compact over time and require topping up.
- The loose surface will be better to walk on than the mud but not be as easy to walk on as tarmac.
- The trees will shed their leaves in the autumn so although the footway should remain free of mud it will have a covering of leaves.
- The bolt down kerbs may become loose if vehicles were to continually bump up them as they will have no concrete backing to retain them.
- If parked on the loose road planning may be dragged onto the carriageway.

Therefore it will be down to the Braintree LHP Members to decide on whether they wish to implement the Cellular Confinement system or cancel the scheme.

## BRAINTREE DISTRICT COUNCIL WITH ESSEX COUNTY COUNCIL LOCAL HIGHWAY PANEL – 18<sup>th</sup> JANUARY 2016

The Braintree LHP has fully allocated their budget for the 15/16 financial year. All potential schemes on the following pages are for consideration only and funding allocation in the 2016/17 financial year. All costings shown are estimates only and are subject to unforeseen site conditions / restrictions once work is undertaken.

Currently the total of all potential schemes are to the value of **£379,500**.

The following list identifies all of the scheme requests which have fed into the Braintree LHP. The RAG column acknowledges what the status of the scheme request is as below:



= The scheme has been validated as being feasible and is available for consideration.



= The scheme has previously been approved for a feasibility study and the results are awaited before the scheme can be fully considered.



= The scheme request is against ECC criteria.



= A scheme request has been received and is in the initial validation process.

## Safer Roads

### Safer Roads

<b>Total Value of schemes</b>	<b>£92,000</b>
-------------------------------	----------------

Ref	Location	Description	Requested By	Scheme stage	Cost Code	Estimated cost	Comments	RAG
1	The Avenue j/w Newland Street, Witham - crossroads	An indicative right turn phase for motorists travelling south be installed. This will require an additional right turn signal head installed on the existing signals on the south western corner of the junction.	Road Safety Officer	Implementation		£25,000	In detailed design	
2	A1124 100 yards South of Church Hill, Earls Colne	The existing mini roundabout is poor, with insufficient deflection to reduce traffic speeds. The existing central island is in the wrong location and traffic speeds remain high on the approaches. The kerbs are to be built out to offer greater deflection to slow motorists down. The central island/ dome to be relocated to a more central position helping to reduce speeds across the junction	Road Safety Officer	Implementation		£18,000	In detailed design	
3	B1018 Witham Road j/w Temple Lane, Silver End	It is proposed to undertake a study to ascertain if the junction could be reconfigured to a normal junction, replacing the existing Bennett junction.	Road Safety Officer	Design		£5,000		



## Safer Roads

Ref	Location	Description	Requested By	Scheme stage	Cost Code	Estimated cost	Comments	RAG
4	Halstead Road j/w Queen Street (Braintree Corner),	The existing advanced give way signage should be relocated 100yds to the junction. The junction to be reconfigured to a normal junction, replacing the existing junction.	Road Safety Officer	Implementation		£10,000	In detailed design	
5	London Road j/w Godlings Way, Braintree	Improved signage for the National cycle way and cycle warning signage. The location of the Bus stop to be reviewed as it is sighted opposite a junction and a Bus cage marking should be painted on the carriageway. The existing telegraph pole within the visibility splay for Godlings Way should be relocated to the back of the footway.	Road Safety Officer	Implementation		£16,000	In detailed design	
6	Maldon Road approx. 100 metres North of j/w Blackman Way, Witham	Provide new zebrite belisha beacons. Complete a scrim survey to ascertain the extents of the below standard surfacing. Provide pedestrian crossing warning sign on the northbound approach. Refresh the crossing carpet, and approach zig zag markings. Provide "Slow" road markings adjacent to the new advanced signing.	Road Safety Officer	Implementation		£8,000	In detailed design	

## Safer Roads

Ref	Location	Description	Requested By	Scheme stage	Cost Code	Estimated cost	Comments	RAG
7	High Street near The Boars Head, Braintree 20 yards from j/w St Michael's Road.	Due to the junction width it is proposed that the junction is built out on the northern side, so that any motorists travelling east then south will be presented with a build out to deter them from driving into the one way section, it may be necessary to have a overrun area rather than build out if larger vehicles are unable to make the turn from the junction to continue north/west on High Street. The existing illuminated sign to be relocated onto the build out. "No Entry Road" markings to be applied to the carriageway surface at the junction mouth.	Road Safety Officer	Implementation		£10,000	In detailed design	

## Traffic Management

### Traffic Management

<b>Total Value of schemes</b>	<b>£237,500</b>
-------------------------------	-----------------

Ref	Location	Description	Problem	Requested By	Scheme stage	Cost Code	Estimated cost	Comments	RAG
1	Locations in Silver end	Validation - Request for 20mph zones at numerous location due to speeding vehicles	Speeding of vehicles	Silver end Parish Council	Surveys	LBRA142111	£0	Awaiting further information on Zones from Cllr Abbott and Parish council	
2	Temple Lane, Silver End	Look to install bend warning signs	No signage to make drivers aware of the tight bends and there has been numerous accidents.	Cllr Abbott		LBRA142124	£0	Against Officer recommendation - The visibility of the bend is good. The traffic signs manual chapter 4 regarding bend ahead warning signs (TSRGD diag 512) states that this sign should be used sparingly and only to indicate a bend hazard. There have been no accidents on ECC data regarding this junction.	
3	Pickpocket Lane, Black Notley	Install 'Unsuitable for motor vehicle signs' on London road and Bakers Lane to prevent vehicles mistakenly using Pickpocket lane.	Pickpocket Lane is a public right of way It is not a made up public road, yet drivers – often misled by Sat Navs, attempt to drive down it and get stuck and then have to be pulled out.	Cllr Abbott	Total scheme		£4,000		
4	High Street, Great Bardfield	The island (Green) to be reduced in size at the junction to allow space for vehicles to make the turn easier.	Vehicles (HGVs) are unable to make the turn movement and are over running the green.	Great Bardfield Parish Council	Total scheme	LBRA152054	£21,000		

## Traffic Management

Ref	Location	Description	Problem	Requested By	Scheme stage	Cost Code	Estimated cost	Comments	RAG
5	The Grove j/w Pasture road, Witham	Relocate the existing blue width restriction sign along The Grove and upgrade it to a larger sign.	It has becoming a regular problem that the HGVs turn into Pasture Road to then meet the restrictions and then have to reverse back on to the "Tesco" roundabout	Cllr Abbott	Total scheme	LBRA152059	£3,000	It was noted during the site visit that the advance warning signage for the width restriction is obscured by vegetation as it presently resides under a tree. There is space to install the signage on the existing street lamp column and install an additional support post in the verge.	
6	London Road j/w Inworth Road, Feering	Feasibility Study - The survey results have highlighted a problem with vehicles entering and exiting Inworth Road. The feasibility will provide a report of what can improve the junction with cost options. (Caveat - as the scheme may need modelling it could increase the cost)	Traffic current backs up some distance on Inworth Road as it is very difficult to exit right into London Road with the volume of traffic.	Cllr Lady Newton	Feasibility	LBRA152011	£0	Awaiting feasibility completion	
7	Chipping Hill Bridge, Chipping Hill j/w Powers Hall End, Witham	To look at options to improve signage and traffic calming measures.	The bridge is not wide enough for two vehicle and motorists speed up to get over the bridge before oncoming vehicles. Drivers then get frustrated at having to wait for a series of vehicles to pass. The visibility is poor, due to the hump of the bridge and the high bridge parapet, particularly for smaller cars.	District Cllr Rose	Feasibility	LBRA152012	£0	Awaiting feasibility completion	
8	Chipping Hill, Witham	To investigate the site in detail and provide options.	After the fatality in October 2014, the Road Safety Engineer requested that a PV2 was carried out assess the footfall at this location.	Road Safety Officer	Feasibility	LBRA152013	£0	Awaiting feasibility completion	

## Traffic Management

Ref	Location	Descripton	Problem	Requested By	Scheme stage	Cost Code	Estimated cost	Comments	RAG
9	Guithavon Valley Witham	Install tactile crossing point where alleyway from Collingwood Road emerges on to Guithavon Valley; and on opposite side of road. Extend the existing double yellow lines to cover the new crossing point.	Improve safety and access for all users – current arrangements are not up to modern standards.	Cllr Abbott	Total scheme	LBRA152101	£6,000	Additional locations being looked into, following site visit with Cllr Abbott and Cllr Mitchell	
10	Valentine Way, Silver End	Install grasscrete along priority 2 sections of Valentine Way.	The verge has been in a deteriorating state due to vehicles being parked on it.	Cllr Abbott	Implementation		tbc		
11	Swan street, Sible hedingham	Detailed design to upgrading the current Zebra crossing to a signalised.	There have been numerous near misses sue to the poor visibility of the crossing	Sible Hedingham Parish Council and Cllr Finch	Design	LBRA152083	£25,000		
12	Park Road and the Northern section of Church Road, Rivenhall	A review of the current measures, including signage and lining. Also consider what other measures could be introduced such as a reduction in the speed limit and no overtaking markings.	Concerns about the speed of the vehicles driving along this stretch of road. The whole of Park Road and the Northern section of Church Road has been subject to frequent crashes over many years	Cllr Abbott/Rivenhall Parish Council	Total scheme	LBRA152089	£0	In validation	
13	Pelly Avenue, Witham	Install grasscrete or parking bays along Pelly Ave within the grass verge.	Inconsiderate parking, congestion and a regular maintenance issue with the grass verge	Cllr Louis	Total scheme	LBRA152091	£85,000	It is recommended that this particular scheme request be reviewed carefully before deciding whether to progress with any further design work and implementation. Installing such a feature may lead to other locations requesting it too.	

## Traffic Management

Ref	Location	Description	Problem	Requested By	Scheme stage	Cost Code	Estimated cost	Comments	RAG
14	Swan Street, Sible Hedingham	To install a VAS/SID along Swan Street as you enter the village.	the speed of vehicles as they enter the village	Cllr Finch	Total scheme	LBRA152092	£8,500		
15	Mill Lane/Guithavon Valley, Witham	Guithavon Valley - The existing bend warning sign should be removed and new bend warning sign placed at the boundary of 25 and 27 to face southbound. All white lining to be refreshed. Mini Double Roundabouts - Signing and lining to be corrected on all approaches. All signs should be removed and the correct arrangement replaced. The 2 roundabout signs mounted on lamp columns are to be renewed with grey backed board. The lining should be removed and correct arrangement laid. The mini roundabouts be domed to encourage drivers to manoeuvre around them creating through deflection. Mill Lane - The right hand bend sign be removed. The double bend warning sign at the boundary of 44 and Clifton House should be removed and correct double bend warning sign installed. The double bend warning sign at the boundary of Lingards and number 1 The Orchards should be removed. The double bend warning sign on LC 4 should be removed and a new cantilever post and sign erected at the back of the footway adjacent to the boundary wall of number 21.	Speeding of vehicles along the road and at the 2 mini roundabouts.	Cllr Abbott/Cllr Rose	Total scheme		£36,500	Recommendation from the feasibility report	
16	Notley Road, Braintree, outside John Ray Junior School	Install 3 guard rails set back from the carriageway to aid the safety of pedestrian at the Crossing Patrol	Vehicles often park and subsequently reverse onto a busy road at the exact point where the Crossing Patrol work	School Crossing Patrol/Cllr Butland	Total scheme		£6,000		
17	A1124, Halstead	Signage on both approaches to the vehicle accesses of Parley Beam cottages to alert vehicles of the vehicles joining or leaving the A1124.	A number of accidents and rear shunts to vehicles due to drivers not aware of the accesses.	Cllr Pike	Total scheme	LBRA152107	£0	The request is against policy. This is a vehicle access to a set of properties and installing signage would confuse drivers as there is no clear junctions.	

## Traffic Management

Ref	Location	Descripton	Problem	Requested By	Scheme stage	Cost Code	Estimated cost	Comments	RAG
18	Powers Hall End, Witham	Improvements to make the school entrance more visable.	Speed issues along the road and a recent accident by the school.	Priti Patel MP/Cllr Louis	Total scheme	LBRA152108	£0	In validation/waiting info from cllr's	
19	A1017, between Baythorne End and Ridgwell	To introduce traffic calming measures	The speed along The Causeway and Four Ash Hill is dangerous and causing a concern to locals	Cllr Finch/Ridgewell Parish Council	Total scheme	LBRA152081	£0	Against officers recommendation - This section of the A1017 (The Causeway and Four Ash Hill) are Priority 1 routes, 60mph speed limit and limited vehicles fronting the carriageway. There have been 2 slight accidents in the last 5 years, 1 on either road and no cluster of similar incidents. The 7day mean average East of The Causeway was 44.2mph. West of The Causeway was 51.2mph. Four Ash Hill was 45.2mph. This is good compliance.	
20	North End Road, Little Yeldham	To remove the "Reduce speed now" sub plate on both approaches and install "Oncoming Vehicles In Middle of the Road" (TSRGD Diag No. 575) plate.	Drivers who are not familiar with the road do not appreciate how narrow this section of the road is and do not realise that they will have to stop if they meet an oncoming vehicle, resulting in many near misses and smashed wing mirrors.	Cllr Parker	Total scheme		£1,500		
21	Cut throat Lane, Witham	To implement traffic calming measures	Vehicles are entering the road from Mulberry Gardens at high speeds and causing a concern.	Cllr Abbott	Total scheme		£0	In validation/speed survey	
22	Maldon road j/w Ewell Hall Chase, Kelvedon	Install x2 'Pedestrian in road' signs as you approach the humpback bridge in both directions.	The speed of vehicle as they approach the humpback bridge, with no footpath for pedestrians which is highly used to access the village of Kelvedon	Cllr Lady Newton/Kelvedon Parish Council	Total scheme	LBRA152112	£3,000		

## Traffic Management

Ref	Location	Description	Problem	Requested By	Scheme stage	Cost Code	Estimated cost	Comments	RAG
23	Guithavon Valley, Witham	To investigate the possibility of additional parking bays along Guithavon Valley and for the safety audit to be carried out.	Guithavon Valley has long suffered as a "rat run" for traffic (to/from Chelmsford from/to Braintree and Colchester) wishing to avoid central Witham congestion, leading to problems of reported speeding and anti-social driving habits.	Cllr Mitchell	Feasibility	LBRA152113	£3,000		
24	Dog Chase, Wethersfield	Traffic calming measures	Vehicles speeding along the chase which is dangerous for pedestrians.	Wethersfield Parish Council	Total scheme		£0	No further action - The posted speed at this location is 30mph. The speed survey was carried out from 13-19 October and the 7day mean average was 15.8mph. This is good compliance within a 30mph speed limit.	
25	A1124 Halstead Road, Earls Colne	Measures to reduce the speed of vehicles along the A1124 Halstead Road as they approach the village	Concerns with the speed of vehicle as they enter the village.	Earls Colne Parish	Total scheme	LBRA152115	£0	The request has been validated and there is central hatching where there is space to have it. The request for wide markings is not supported as the village falls under a conservation area and the lining has to be reduced in width. Existing signage conforms to policy, it is therefore recommended not to proceed with the request.	
26	Church Lane, Doghouse Road, Pattiswick	2 speed surveys	There are no roadside footways and residents, including children have to walk in the road where they are in potential conflict with vehicles.	Cllr Abbott	Total scheme		£0	The average daily speed (7days) on both roads are all below 30mph and therefore good compliance with the current 60mph speed limit. There have been no accidents reported at this location of which the location is very rural.	



## Traffic Management

Ref	Location	Descripton	Problem	Requested By	Scheme stage	Cost Code	Estimated cost	Comments	RAG
27	Cressing road, Braintree south of Stubbs Lane	Feasibility study for the installation of a Zebra/signalised crossing	Pedestrains and school children are having problems crossing the road.	Cllr Lady Newton	Feasibility	LBRA152117	£10,000		
28	A1017 - Stumer, New England and Baythorne End	To reduce the speed limits between these three locations	To assess the speed of vehicles travelling along this stretch of road to see the speed can be reduced.	Birdbrook Parish Council	Total scheme		£0	Against policy. Between 2009 and 2012 Essex County Council carried out a Speed Limit Review throughout Essex on all Priority 1 and 2 routes as suggested by the DfT of which Baythorne End, New England and Sturmer along the A1017 were deemed the appropriate speed. The recent speed surveys carried out highlight that the speed limits at these locations are appropriate. There has been 3 accidents along this whole stretch and doesnt warrant a casualty reduction scheme.	
29	Francis Way j/w Broadway, Silver End	Install tactile crossings at Francis Way j/w Broadway and improve the drainage due to ponding in the vacinity of the crossing. Also install tactile crossing adjacent to the shops/Library.	There is no dropped kerb at the crossing point where Francis Way meets Broadway.	Cllr Abbott	Total scheme	LBRA152118	£15,000		
30	Tey Road, Coggeshall	School warning signs for Soaring High Montessori Primary School	Emergency vehicles have difficulty finding it and sat navs seem to direct vehicles to the Bird in Hand and Blackwell's Farm.	Cllr Lady Newton	Total scheme	LBRA152119	£0	As this school forms part of a private school company, it is specialised and anybody going to the school would have instructions how to get to it. It is against DfT guidelines as set out in the Traffic Signs Manual Chapter 4 to install signage prior to the school from the B1024 as it is not a facility for all to use.	

## Traffic Management

Ref	Location	Descripton	Problem	Requested By	Scheme stage	Cost Code	Estimated cost	Comments	RAG
31	Queenborough Lane and Bridge End Lane, Great Notley	3 speed surveys	To assess the speed of vehicles within the 20mph zone.	Cllr Walters	Surveys	LBRA152090	£0	The average daily speed (7days) along Queensborough were 17.4mph north of the road and 21.2mph at the south. The survey carried out along Bridge End Lane had an average of 19.4mph and therefore good compliance with the current 20mph speed limit. There have been no accidents reported at this location.	
32	Outside no. 30 St Peters Road, Coggeshall	1 speed survey to assess if a SID can be considered.	Traffic speeding along this road is becoming a major issue, especially as part of this road has no pavement on one side, therefore access from houses is often blind.	Coggeshall Parish Council	Total scheme	LBRA152096	£0	Against policy. St Peters Road is 30mph. The 7day mean average was 30.1mph southbound and 27.9mph northbound. For a SID to be considered the 7day average needs to be 5mph over the posted limit.	
33	Kelvedon road, coggeshall	Install a VAS travelling southbound.	speeding along this road is becoming a major issue as they enter the village	Coggeshall Parish Council	Total scheme	LBRA152121	£10,000	The speed survey met the criteria for a VAS to be installed travelling southbound	
34	Outside Entrance Highfields 96/98 West Street, Coggeshall	Extending the current 30mph speed limit.	Concern with vehicles travelling fast as they enter the Village within the 40mph speed limit. Previous survey positioned too close to the village and consequently did not give truly representative results	Coggeshall Parish Council	Total scheme	LBRA152095	£0	Against policy. West Street is currently a 40mph speed limit. The 7day mean average was 30.2mph eastbound and 31.8mph westbound. This is good compliance for a 40mph speed limit.	

## Traffic Management

Ref	Location	Descripton	Problem	Requested By	Scheme stage	Cost Code	Estimated cost	Comments	RAG
35	Outside The Mount, 71 East Street, Coggeshall	1 speed survey	Excessive speed of vehicles as they approach the village. Previous survey positioned too close to the village and consequently did not give truly representative results	Coggeshall Parish Council	Total scheme	LBRA152098	£0	East Street is currently a 30mph speed limit. The 7day mean average was 29.2mph eastbound and 30.5mph westbound. This is good compliance for a 30mph speed limit.	
36	London road, Braintree - South of Meadow Park	To upgraded the pedestrain refuge to a zebra crossing	The speed of vehicles are excessive and a zebra will make it easier for local residents, to cross the road safely.	Cllr Dunn	Total scheme		£0	Against policy - where the PV2 value is below 0.2, then a crossing facility would not be justified. The PV2 result at this location was 0.144. London Road is a PR1 with a speed limit of 40mph and for this reason it would need to be a signalised crossing. To meet the criteria for a signalised crossing the PV2 value needs to be above 0.7.	
37	B1389 Hatfield road, Witham	Install Keep Clear markings outside Home Bridge Manor	Concerns with the access and the close proximity to the busy Spinks Lane junction that any vehicle travelling southwards wishing to turn right into Homebridge Court are unable to do so because of queuing traffic	Witham Town Council	Total scheme	LBRA152122	£0	In validation	
38	63 Head Street, Halstead	Install a bollard	HGVs are mounting the kerb close to number 63 and very close to the property.	Cllr Sutton	Total scheme	LBRA152126	£0	In validation	
39	High Street, Kelvedon	Improve the gradiant of the access to the Go-Ahead Group depot	The buses are scrapping the underline of the bonnet on the carriageway	Cllr Lady Newton	Total scheme	LBRA152127	£0	In validation	

## Traffic Management

Ref	Location	Descripton	Problem	Requested By	Scheme stage	Cost Code	Estimated cost	Comments	RAG
40	Finchingfield Road, Steeple Bumpstead	Install an official layby	The verge is highly used by hearses and thoses attend funerals, which is rutting the verge.	Cllr Westrope and Cllr Finch	Total scheme	LBRA152128	£0	In validation	
41	Panfield Lane j/w Rayne Road, Braintree	Install a No Left Turn.	Vehicles are using it as a cut through to avoid Aetheric Road.	Cllr Banthorpe	Total scheme	LBRA152129	£0	In validation	
42	The Street, Shalford	Traffic calming measures	The speed of vehicles entering the village is becoming very dangerous for locals	Shalford Parish Council	Total scheme		£0	Speed survey	

## Walking

### Walking

Total Value of schemes	£5,000
------------------------	--------

Ref	Location	Description	Problem	Requested By	Scheme stage	Cost Code	Estimated cost	Comments	RAG
1	Boars Tye Road, Silver End	Design only - Footway Extension (Ralph's Farm to Brettons 400m)	Building the path from where it ends now out to the first house be completed. It would help with walking for recreation, walking dogs, getting to the shops, doctors and work.	Historical scheme	Design	LBRA132079	£0	Awaiting Design completion. However, the delivery cost will be in the region of £240k. £200k civils work, £20k telegraph pole diversion and £20k traffic management.	
2	Colne Road, Coggeshall	Feasibility study - There are three possible options. 1) construct a footway across the private accesses of the houses, but this will require land acquisition and possible objections. 2) construct a short footway following from the existing on the right of Colne Road. This may also require land acquisition but as it is not used for vehicular accesses it may be easier to negotiate. 3) install a build out on the right hand side of Colne Road that would not require land. It would connect both footways and would also be a traffic calming feature.	There is no footway from Brick Kiln Close to the fire station causing pedestrians (some with push-chairs or the elderly) to walk in the highway.	Cllr Lady Newton	Feasibility	LBRA153002	£0	Awaiting feasibility completion	

## Walking

Ref	Location	Descripton	Problem	Requested By	Scheme stage	Cost Code	Estimated cost	Comments	RAG
3	Hill lane j/w the A1017, Sturmer	Improve the current footway and install dropped crossing with tactile paving	A lack of footway at the junction of Hill lane and the A1017	Sturmer Parish	Feasibility		£5,000	A dropped crossing can be installed. However, the footway is very narrow for both pedestrians and those on mobility scooters. A feasibility study to investigate the footway widening, including the dropped crossing would be the preferred option as it would not be good practice installing a dropped crossing on a narrow footway.	
4	Sudbury Road, Castle Hedingham	To install a footway from the j/w Rosemary Lane along Sudbury Road to meet the existing footway.	No footpath into Castle Hedingham from Sudbury Road. Pedestrains have to walk in the road to gain access to the footway.	Cllr Finch/Castle Hedingham Parish Council	Total scheme	LBRA153009	£0	The footfall survey highlighted limited pedestrains in the 48hrs survey. The width of the verge from the post and railings is 1.2m which cannot be moved as it protects the pond/ditch and the minimum footway needs to be 1.5m. The only option would be to move the ditch which would be very costly. Officers recomendation is to not proceed.	
5	B1389 Bridge Street, Witham	Improvements to the footway	The pathway looks like part of the road and many locals are concerned that cars are not distinguishing between the road and pavement.	Cllr Louis	Total scheme	LBRA152123	£0	In validation	

## Quiet Lanes

### Quiet Lanes

Total Value of schemes	£45,000
------------------------	---------

Ref	Location	Descripton	Problem	Requested By	Scheme stage	Cost Code	Estimated cost	Comments	RAG
1	Sheepcotes Lane, Silver End	Implementation of a Quiet Lane.	Highly used by walkers.	Cllr Abbott	Total scheme	LBRA152106	£6,000		
2	Lamb Lane, Innham Hill and Southey Green, Sible Hedingham	Implementation of the 3 location as Quiet lanes.	Concerns with the speed of vehicle as this road is highly used by walkers, horse riders, cyclists and families	Sible Hedingham Parish Council and Cllr Finch	Total scheme	LBRA152093	£15,000	All three location meet the criteria for Quiet lanes.	
3	Rectory Lane, Rivenhall	Implementation of a Quiet Lane.	This lane is highly used by walkers.	Cllr Abbott/Rivenhall Parish Council	Surveys	LBRA152109	£6,000		
4	Water Lane, Shalford	Implementation of a Quiet Lane.	The road is highly used by dog walkers and families due to the number of footpaths in the area.	Shalford Parish Council/Cllr Walters	Total scheme		£6,000		
5	Tey Road and America Road, Earls Colne	Implementation of a Quiet lane.	Highly used by walkers and those with children.	Earls Colne Parish	Total scheme	LBRA152124	£0	In validation/speed survey	
6	Newhouse Road and Nightingale Hall Road, Earls Colne	Implementation of a Quiet lane.	Highly used by walkers and those with children.	Earls Colne Parish	Total scheme	LBRA152125	£0	In validation/speed survey	

## Quiet Lanes

Ref	Location	Descripton	Problem	Requested By	Scheme stage	Cost Code	Estimated cost	Comments	RAG
7	Liston Lane, Liston	Implementation of a Quiet Lane.	Highly used by walkers.	Foxearth and Liston Parish Council	Total scheme		£6,000		
8	Woolpits Road, Great Saling	Implementation of a Quiet Lane.	Highly used by walkers.	Great Saling Parish Council	Total scheme	LBRA152120	£6,000		



**Braintree District Approved Scheme List**

<b>Key:</b>	<b>Completed schemes</b>
	<b>Cancelled schemes</b>

REF	COST CODE	SCHEME NAME	CURRENT STAGE	ANTICIPATED COMPLETION DATE	WORK DESCRIPTION	ALLOCATED BUDGET	COMMENTS
-----	-----------	-------------	---------------	-----------------------------	------------------	------------------	----------

**2012/13 Budget Capital Schemes**

1	LBRA003001	Inworth Road, Feering	In Progress	tbc	Footway (new)	£120,000	CPO process.
---	------------	-----------------------	-------------	-----	---------------	----------	--------------

**2013/14 Budget Capital Schemes**

2	LBRA132079	Boars tye Road, Silver End	In Progress	29/01/2016	<b>Design</b> - Footway Extension (Ralph's Farm to Brettons 400m)	£6,000	
3	LBRA134004	Braintree Town	On Hold	tbc	No signing provided to avoid A120 or other main roads. The signs will cover the Braintree town area including the surrounding villages.	£50,000	On hold. Awaiting the ECC cycling strategy to be completed.

**2014/15 Approved Capital Schemes**

4	LBRA141001	Deanery Hill/Church Lane, Bocking	In Progress	26/02/2016	Casualty Reduction scheme	£14,000	
5	LBRA142006	B1018 Braintree Road, Cressing	In Progress	N/A	Carriageway widening, install a footpath and new kerbing.	£200,000	Land acquisitions issues being discussed with land owner.
6	LBRA142012	Guildhall, Church Hill, Finchingfield	Completed	14/12/2015	Install new signs (530, 530.1) on a grey backing board and black post and place SLOW carriageway marking (1024) on site. (Site A) Install a Vehicular Activated Sign by the lamp Column opposite the gateway to the church, this would be placed on a black pos	£14,000	
7	LBRA142013	Blue Mills Hill and Maldon Road	Completed	26/11/2015	Design - Install a footpath along Blue Mills Hill, Witham, connecting the Bridleway to the existing footpath on Maldon Road.	£7,000	
8	LBRA142018	Junction of Bridge Street/Colchester Road/Station Hill, Bures Hamlet	In Progress	29/04/2016	Install a central safety refuge	£25,000	
9	LBRA142019	Station Road Earls Colne	In Progress	29/01/2016	Add additional "Junction" sign and add carriageway edge line across Industrial Estate entrance.	£8,000	
10	LBRA142020	Colneford Hill/Colne Park Road, White Colne	In Progress	N/A	Install kerbing to overrun area due to continual damage to of the Village Green.	£18,500	Land ownership issues to be resolved. Letter sent to Owner.
11	LBRA142021	Village Green, White Colne	In Progress	N/A	Install concrete kerbing around the Colne Park Road section of the village Green.	£6,500	Land ownership issues to be resolved. Letter sent to Owner.
12	LBRA142032	Spa Road, Witham (Toucan) Design and Install	In Progress	29/04/2016	Design and Install a Toucan crossing	£0	
13	LBRA142037	Broad Road, Braintree	In Progress	27/05/2016	Broad Road, Braintree	£9,500	
14	LBRA142056	Sloe Hill, Halstead	Completed	14/12/2015	Install a Speed Indicator Device along Sloe Hill within the 30mph limit.	£8,500	
15	LBRA142058	Church Road and Oak Road, Rivenhall	In Progress	26/02/2016	Replace ADS sign to include HGV alternative route to avoid low bridge; Replace Blue advance warning sign to remove the weight restriction signs add lighting unit to eastern sign; Add Height restriction signage on eastern side at weight restriction terminal.	£8,500	
16	LBRA142061	Coggeshall Road, Feering	In Progress	15/02/2016	Install 2No additional height restriction warning signs North and South bound.	£14,000	
17	LBRA142122	Church Road, Rivenhall	In Progress	01/07/2016	To extend the existing 30mph speed limit North by an additional 100 metres.	£6,000	Delivery date slipped due to obection received

**2015/16 Approved Capital Schemes**

18	LBRA151002	Courtauld Road north bound approach to Julien Court Road	In Progress	18/03/2016	To implement	£12,000	
19	LBRA151003	B1024 jw A1124, Earls Colne	Completed	16/11/2015	To implement	£5,000	
20	LBRA151004	(Casualty Reduction Scheme) - Halstead Road j/w Queen Street, Braintree	In Progress	26/02/2016	Advanced Design	£15,000	
21		(Casualty Reduction Scheme) - High Street j/w St Michaels Road, Braintree	In Progress	29/02/2016	Advanced Design	"	
22		(Casualty Reduction Scheme) - London Road j/w Godlings Way, Braintree	In Progress	29/02/2016	Advanced Design	"	
23		(Casualty Reduction Scheme) - Maldon Road j/w Blackman Way	In Progress	26/02/2016	Advanced Design	"	
24		(Casualty Reduction Scheme) - A1124 Approx 100yds South Church Hill	In Progress	29/02/2016	Advanced Design	"	
25		(Casualty Reduction Scheme) - The Avenue from Newland Street Crossroads	In Progress	29/02/2016	Advanced Design	"	

26	LBRA152002	Church street, Great Maplestead	In Progress	28/09/2016	Install a 20mph limit in the vicinity of St Giles Primary School, Church Street. Signage and TRO (including lit terminal signs)	£7,000	
27	LBRA152003	Spa Road, Witham	Completed	23/10/2015	Install 2x 'Slow – Children Crossing' signs.	£2,500	
28	LBRA152004	Oak Road, Rivenhall	Completed	21/10/2015	Install a small area of grasscrete outside house nos. 51 – 53.	£3,000	
29	LBRA152005	The Grove j/w Maldon Road	In Progress	11/03/2016	Install 2x warning signs of mini roundabout ahead.	£5,000	
30	LBRA152007	Trinity Street, Halstead	In Progress	18/03/2016	Install 1 or 2 warning signs of Wildfowl Crossing along Trinity Street	£2,000	
31	LBRA152008	Castle Heddingham	In Progress	26/08/2016	Install signage and TRO's for 7.5T Weight Limit.	£31,800	
32	LBRA152009	B1057 Dunmow Road, Great Bardfield	In Progress	25/01/2016	Install a VAS along Dunmow Road before the development of houses North-East Bound.	£8,500	
33	LBRA152010	Lawrence Avenue j/w Pelly Avenue, Witham	Completed	23/10/2015	Install 1x children warning sign	£5,000	
34	LBRA152011	London Road j/w Inworth Road, Ferring	In Progress	26/02/2016	<b>Feasibility Study</b> - The survey results have highlighted a problem with vehicles entering and exiting Inworth Road. The feasibility will provide a report of what can improve the junction with cost options.	£18,000	
35	LBRA152012	Chipping Hill Bridge, Chipping Hill j/w Powers Hall End, Witham	In Progress	29/01/2016	<b>Feasibility study</b> - To look at options to improve signage and traffic calming measures.	£3,000	
36	LBRA152013	Chipping Hill, Witham	In Progress	29/01/2016	<b>Feasibility study</b> - After the fatality in October 2014, the Road Safety Engineer requested that the site is investigate in detail and provide options. PV2 met the criteria for crossing facility.	£5,000	
37	LBRA152014	Cut Throat Lane, Witham	In Progress	17/06/2016	Convert 2 pedestrian accesses to ramped access; Upgrading 1 pedestrian access steps with handrail.	£27,000	
38	LBRA152016	Entrances to Feering Village	In Progress	27/05/2016	Install 30mph Roundel at top of Dragons teeth by the 30mph speed limit terminal sign along London Road and Inworth Road.	£1,650	Date moved due to lining works better during the dryer months.
39	LBRA152018	Queenborough Lane j/w New Road, Rayne	In Progress	15/04/2016	Install a new Footway sign and a Road Narrow sign along New Road; Remove all centre lining from the brow of hill around the bend; Install Road Narrow sign outside Autumn Lodge.	£7,000	
40	LBRA152019	Church Street, Steeple Bumpstead	In Progress	01/07/2016	Install additional Advanced warning 6.6 width restriction sign and sub plate by the bench, along Finchingfield Road; Remove road narrow and sub plate from BT pole in Church Street. Install new post with – Road Narrow sign & sub plate and 6.6 Width restriction.	£7,500	
41	LBRA152020	Brunwin Road j/w Shalford Road, Rayne	In Progress	27/05/2016	Extend the double yellow lines (approximately 20m) along Shalford Road to the top of the ramp outside property No 29.	£2,500	
42	LBRA152021	Sudbury Road, Little Maplestead	In Progress	22/03/2016	Install 15 x Verge Marker posts	£7,500	
43	LBRA152022	Mill Lane/Guithavon Valley, Witham	Completed	07/08/2015	Feasibility study - to determine if deflection can be increased at the roundabouts and options of improvements to the junction.	£3,000	
44	LBRA152023	Colne Road to the A120	In Progress	26/02/2016	Feasibility study - dedicated left hand lane from Colne Road to the A120.	£3,000	
45	LBRA152031	Normandie Way J/W Colchester Road, Bures Hamlet	Completed	23/10/2015	Installation of a solar powered VAS on existing wide based post facing northbound vehicles. With data collection units.	£7,500	
46	LBRA152039	School Road, Silver End	In Progress	25/03/2016	Installation of a tarmac cross-over strip from footway to grasscrete	£14,000	
47	LBRA152040	Colchester Road, Bures Hamlet - Bollards	In Progress	30/03/2016	Install 2x bollards on the verge next to the Millennium Bridge footway.	£3,000	
48	LBRA152042	Panfield Lane, between junction with Aetheric Road and Rayne Road	In Progress	tbc	Implement a One Way TRO with the accompanying signs and lines, for this section of Panfield Lane; A new 'No left turn ahead' sign prior to the junction and also a 'No Entry' marking on the carriageway; New ahead arrows will be installed on the carriageway	£5,000	Delay due to objections received
49	LBRA152055	A1124 Halstead Road, Earls Colne	In Progress	11/03/2016	Install permanent VAS	£8,500	
50	LBRA152058	Weathersfield Road, Finchingfield	In Progress	11/03/2016	Install a VAS	£8,500	
51	LBRA152060	Ashton's Corner, B1053 Braintree Road j/w Panfield road and Church end, Panfield	In Progress	20/05/2016	Remove the 2 Church end arms of the junction and in their place provide a single arm, square to the road. This would reduce the number of conflict point from 3 to 1. This would involve installing new kerbing at the bellmoth.	£52,000	
52	LBRA152061	Valentine Way, Silver End	In Progress	08/04/2016	Install grasscrete along sections of Valentine Way and improve the junction kerbing at Leicester and Stretford Court.	£50,000	

53	LBRA152064	A131, Great Notley -Panners roundabout adj to hungry horse public house	In Progress	31/03/2016	To carry out a feasibility study to identify the best location to install a pedestrian crossing facility.	£5,000	
54	LBRA152070	Oak Road, Rivenhall	In Progress	22/04/2016	Install new signage and re-route HGVs to stop the conflict of HGVs getting stuck along this road.	£46,000	Date may slip if any objections are received
55	LBRA152072	Calamint Road, Witham	Completed	22/12/2015	Install 3 dropped kerbs to aid those using mobility scooters and buggies to access other footways, to gain access to the local shops and beyond into town.	£10,000	
56	LBRA152073	Kynaston Road, Panfield	In Progress	25/03/2016	Convert current SID/VAS to solar power	£10,000	
57	LBRA152078	Newland Street j/w The Grove, Witham	In Progress	01/07/2016	Install a tactile crossing at the junction and improve the gradient.	£45,000	
58	LBRA153001	Church Road, Hatfield Peverel	On Hold	N/A	To Install 46m of footway, follow existing f/w width from Ranulph Way, past the property along Church Rd (known as Gables). Back edging and up to the footpath with kerbing. The back edge to be soil and seeded. Optional - Installation of 3 Bollards to prevent vehicles mounting the kerb.	£55,000	Information in report
59	LBRA153002	Colne Road, Coggeshall	In Progress	29/01/2016	FEASIBILITY STUDY - There are three possible options. 1) construct a footway across the private accesses of the houses, but this will require land acquisition and possible objections. 2) construct a short footway following from the existing on the right of Colne Road. This may also require land acquisition but as it is not used for vehicular accesses it may be easier to negotiate. 3) install a build out on the right hand side of Colne Road that would not require land. It would connect both footways and would also be a traffic calming feature.	£4,000	
60	LBRA153006	A131 High Garrett, Braintree	In Progress	28/06/2016	1) Widening of the northern refuge island, Add tactile paving, Replace bollards and Add sign plates. 2) Excavate verge and lay new footway along Church Street. 3) Grove field - Re profile footway for addition of tactile paving (2 sites) and excavate verge and lay new footway. 4) Install new Lining near Grove Field. 5) Install 2x VAS.	£82,000	
61	LBRA153007	Blue Mills Hill Road and Maldon Road	In Progress	15/04/2016	Install a 50m footway along Blue Mills Hill, Witham, connecting the Bridleway to the existing footway on Maldon Road.	£25,000	
62	LBRA155005	Halstead Road, High Garrett. IM135b Crematorium (HI4141)	In Progress	28/06/2016	Install raised kerbs, hard stand and path to Crematorium.	£20,000	
63	LBRA155006	Halstead Road, High Garrett. Opp -Crematorium (HI4142)	In Progress	27/01/2016	Install pole, flag and raised kerbs.	£4,000	
64	LBRA155007	Braintree road j/w Cypress Road, Witham	Completed	07/12/2015	Replace old metal shelter with new metal shelter	£7,000	
65	LBRA155008	The Cemetery, Cypress Road	Completed	07/12/2015	Replace old metal shelter with new metal shelter	£7,000	
66	LBRA158001	Byway 9, Black Notley, also known as Snakey Lane	In Progress	29/01/2015	Laying of road-planings to improve the surface conditions on unbound surface.	£30,000	
67	LBRA158002	Byway 10, Black Notley	In Progress	22/01/2016	Laying of road-planings to improve the surface conditions on unbound surface.	£13,000	
68	LBRA158003	Byway 13, Gestingthorpe	Completed	30/09/2015	Laying of road-planings to improve the surface conditions on unbound surface.	£25,000	